

Courses on the Creek

S. 21° W. 10 3/4 P.
 S. 26. E. 44 1/2
 N. 88. E. 11 1/2
 S. 30. E. 19
 S. 6. E. 27 1/2
 S. 86. E. 6 3/4
 S. 11. E. 30
 S. 51. E. 38
 188 P.

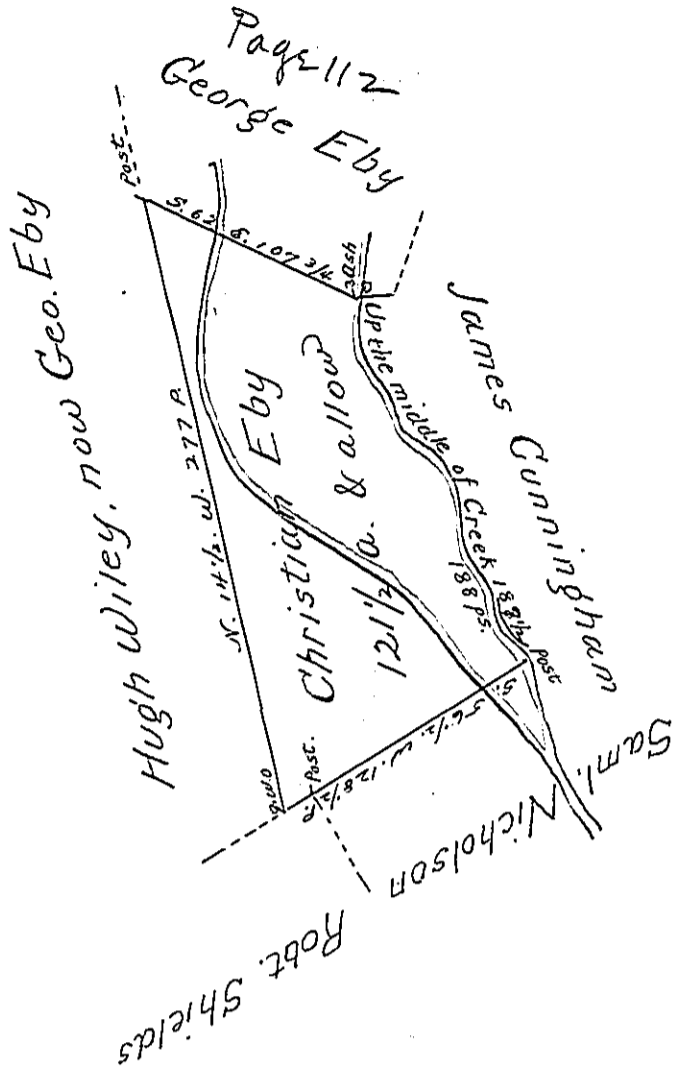

A Draft of a Tract of Land situate in the Township of Betterkenny in the County of Franklin containing one hundred and twenty one acres and an half and the allowance of Six pcent for Roads Survey'd February 29th. 1788 in pursuance of a warrant granted to Christian Eby bearing date the 29th. Day of January 1785 agreeably to an order of the Honorable the Board of Property bearing date the 4th. of February 1788

Matthew Henderson Esq.

To Daniel Brodhead Esquire }
 Surveyor General of Pennsylvania }

IN TESTIMONY that the above is a copy of the original remaining on file in the Department of Internal Affairs of Pennsylvania, made conformably to an Act of Assembly approved the 16th day of February, 1833, I have hereunto set my Hand and caused the Seal of said Department to be affixed at Harrisburg, this sixth day of January 1903

James W. Latta
 Secretary of Internal Affairs.